

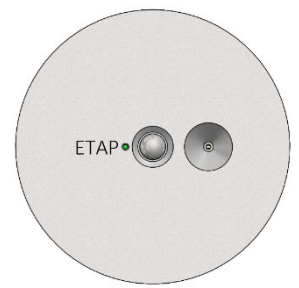

# ETAP Easydim2 Components



ENGLISH

## Mounting and Wiring Instructions

### Controller Surface Mounted C1C30

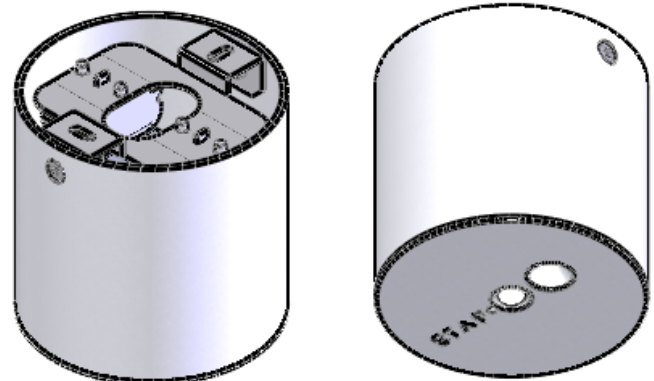
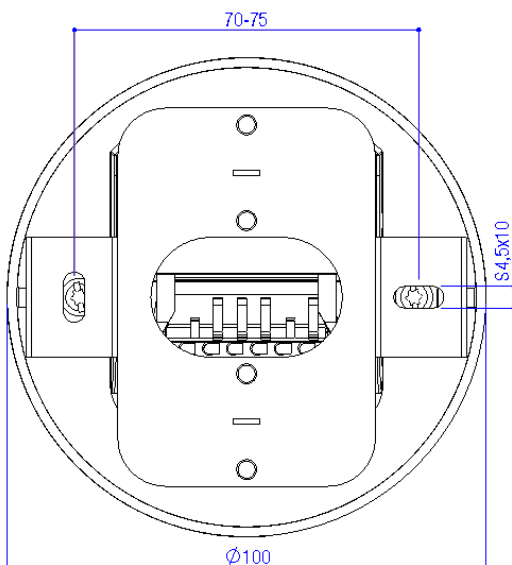
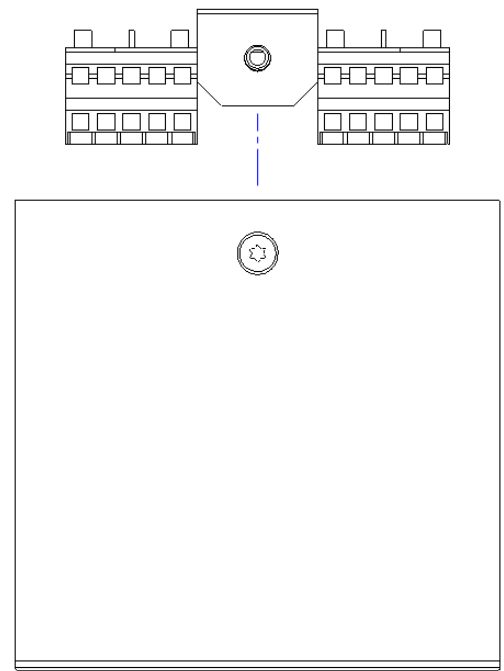
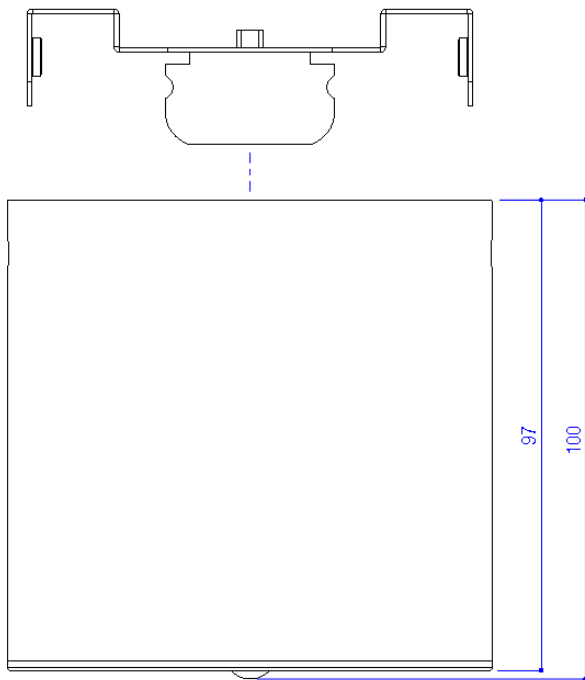

#### Mechanical

The controller for surface mounting has the following dimensions:



Cable entry can be done from above. Although enough connections are provided for through wiring, it is advised to use a separate connection box in case of throughwiring (especially if 2,5mm<sup>2</sup> is used) or where side entry is the only option. In these cases use a rigid surface mount connection box or cable trunk system to mount the C1C30-B to.

## Technical data C1C30

Operating voltage	230V AC 50Hz
Isolation of wires	All wiring needs to be isolated for mains voltage since DALI is NOT SELV!
Current supply to DALI line	See <a href="#">manual</a> on the website section 'System Limits'
Controller Housing Material	ASA  in a powder coated Aluminium cylinder mounted on a Zinc plated iron bracket.
Wiring schemes	See <a href="#">manual</a> on the website section 'Applications'
Working temperature	0 °C ... +50 °C (for reliable PIR movement detection, the temperature difference between moving objects and background should be at least 5°C)
Wire diameter and termination	Connectors accept the following wire types:  Solid conductor : 0.5 ... 2.5 mm <sup>2</sup> Fine-stranded conductor : 0.5 ... 2.5 mm <sup>2</sup> Rigid-stranded conductor : 1.5 ... 2.5 mm <sup>2</sup>    For Easydim2 it is advised to use 1.5mm <sup>2</sup>  Connector housing material: PC White, Inserts: Stainless Steel & Tinned Copper
Default operation	At startup, the operation mode needs to be set by the App.
Dimensions (D x H)	Diam. 100x100mm See dimensional sketch above for details.

The movement detection area is rectangular with the widest view aligned with the springs and the axis along the ETAP logo and sensor openings. The sensor should be mounted in an area with much daylight (if present) and since it is the Bluetooth connection point also near the area where it is most likely someone will be sited to control the lights via the smartphone App.

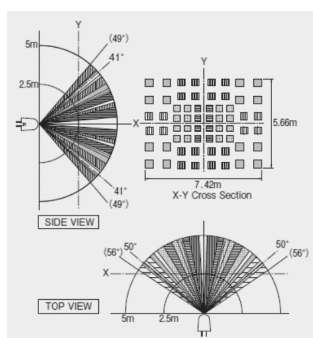

The movement detection area for small movements at a mounting height of 2.8m is about 4x6m, for large movements it is about 6x8m. Max. height for small movement detection is 3,5m.

For expansion sensors and related accessories please consult [www.etaplighting.com](http://www.etaplighting.com)



Conformity with applicable EU directives is confirmed by the CE symbol. Specifications subject to change without notice

ETAP NV – Antwerpsesteenweg 130 - 2390 Malle - Belgium  
Tel. +32 (0)3 310 02 11 – [info.be@etaplighting.com](mailto:info.be@etaplighting.com)  
[www.etaplighting.com](http://www.etaplighting.com)